

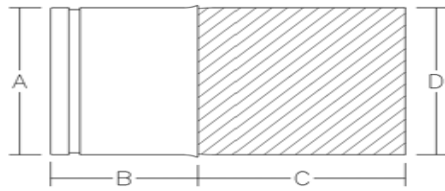

The Ultimate Joining System

Series 1010

PP-R Transition with
Cut Groove



Nominal Size Inches	POLY-CAM Cut Groove Material	Coupling Diameter	Coupling Length	PP-R Length	PP-R Diameter
		<i>A</i>	<i>B</i>	<i>C</i>	<i>D</i>
3/4	Carbon steel, SS 316 , SS 304, SS 303, Epoxy coated	1.200	1.60	6	25
1	Carbon steel, Stainless 316 , Stainless 304, Epoxy coated	1.315	2.00	6	32
1 1/4	Carbon steel, Stainless 316 , Stainless 304, Epoxy coated	1.660	2.60	6	40
1 1/2	Carbon steel, Stainless 316 , Stainless 304, Epoxy coated	1.900	2.60	6	50
2	Carbon steel, Stainless 316 , Stainless 304, Epoxy coated	2.375	3.00	8	63
2.5	Carbon steel, Stainless 316 , Stainless 304, Epoxy coated	2.875	4.00	8	75
3	Carbon steel, Stainless 316 , Stainless 304, Epoxy coated	3.500	4.00	8	90
4	Carbon steel, Stainless 316 , Stainless 304, Epoxy coated	4.500	4.00	8	125
6	Carbon steel, Stainless 316 , Stainless 304, Epoxy coated	6.625	5.00	16	160
8	Carbon steel, Stainless 316 , Stainless 304, Epoxy coated	8.625	6.00	16	200
10	Carbon steel, Stainless 316 , Stainless 304, Epoxy coated	10.750	7.00	24	250
12	Carbon steel, Stainless 316 , Stainless 304, Epoxy coated	12.750	9.00	24	315
14	Carbon steel, Stainless 316 , Stainless 304, Epoxy coated	14.000	9.00	24	355
16	Carbon steel, Stainless 316 , Stainless 304, Epoxy coated	16.000	10.00	24	400
18 Text	Carbon steel, Stainless 316 , Stainless 304, Epoxy coated	18.000	14.00	24	450

Fully pressure rated . Standard SDR sizes 7, 9, 11, 17
Manufactured to D1599, D1598